

MODEL U4-4 TILLER HANDLE STEERING
Shift Cable Assembly 1592

1. Remove the lower plastic cover from the steering handle.
2. Cut out the drill template and center it over the top contour of the handle. Secure with masking tape and center punch the two hole positions.
3. Remove the nut from the ignition key switch and slide the switch out of the socket to clear for drilling holes.
4. Drill the two holes using a 3/16 inch drill.
5. Remove the socket screw from the opposite end of the shift handle and remove the black plastic centering sleeve by tapping on the edge inside the steering arm.
6. Install the aluminum centering sleeve with lever and rod end, using the 8MM x 60MM hex hd bolt.
7. Thread the shift cable all the way into the shift handle rod end. Attach the cable body to the steering arm using the shim, U-clamp, 2 #10-24 x 5/8 screws and lock nuts.

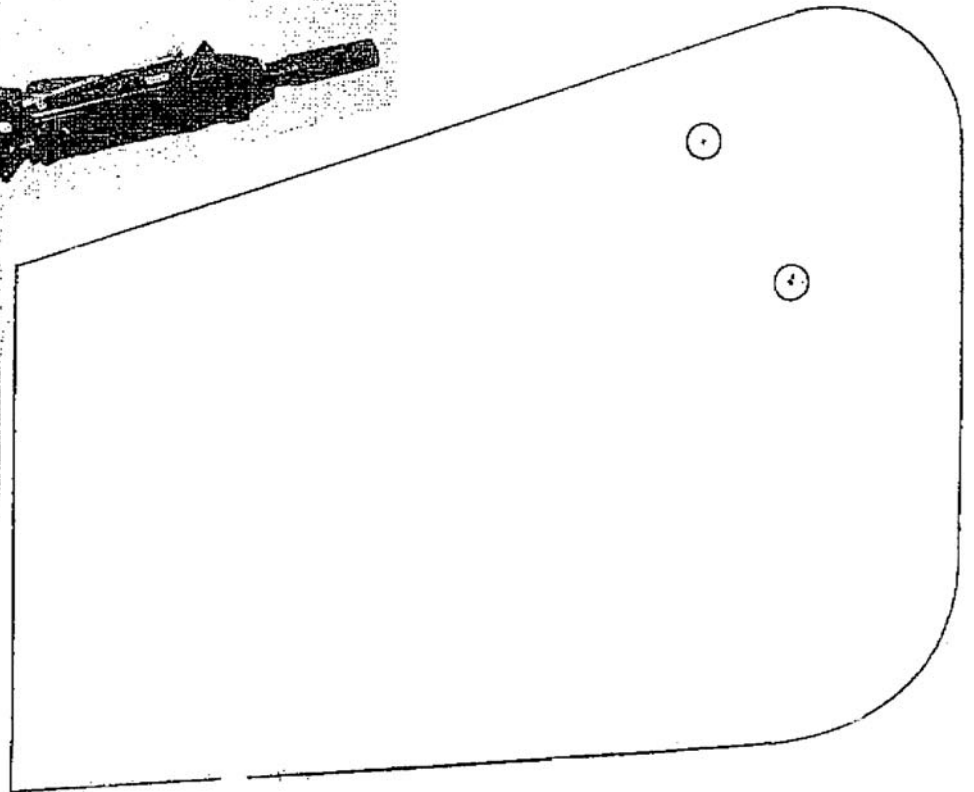
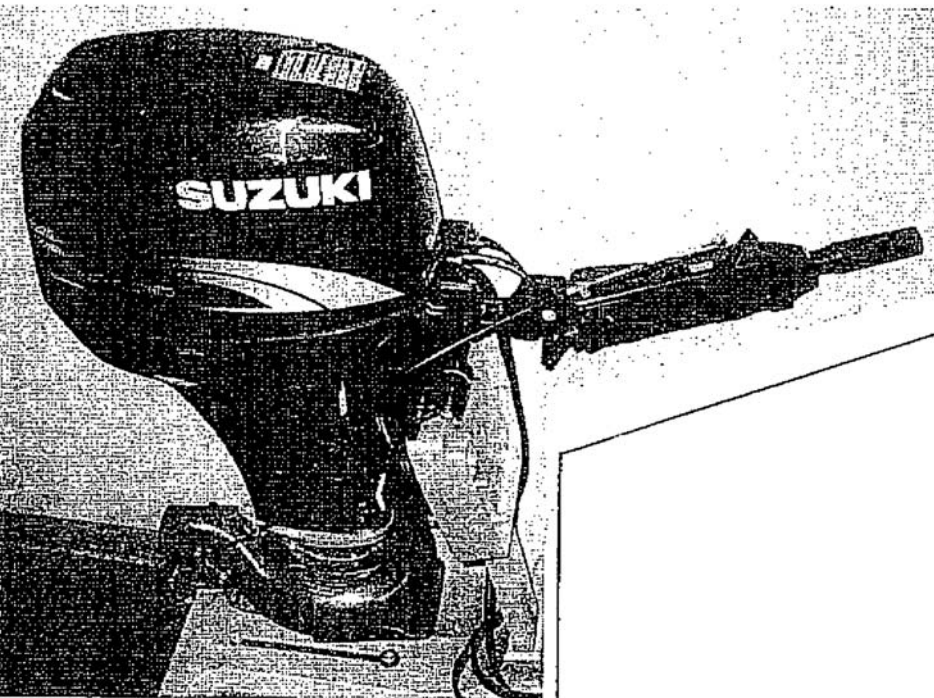

8. Attach the lower end of the cable to the jet drive with the ball rod end threaded on the cable as far as it will go and the cable anchor bracket centered and locked. Twist the cable in the U-clamp so that the cable rests against the motor cowling and tighten the clamp screws. The clamp base is slotted to allow alignment for minimum cable bending.

9. Place the shift handle in forward, solidly in the detent. The reverse gate cam roller must be at the end of the slot in the cam. If these conditions are not met, slide the cable anchor bracket on the jet drive and/or adjust the threaded rod end on the cable.

10. Shift to reverse and back to forward. Do not be concerned if the gate does not reach reverse. There is clearance at this position and water pressure will close the gate.

11. In forward, with the roller at the end of the cam slot, the gate cannot be forcibly rotated toward reverse. Pull on the gate by hand to verify this.

12. Lock the nuts on the cable against the rod ends to complete the adjustment and reassembly the switch and lower cover of the steering arm.

CAUTION! YOU MUST RETURN THE THROTTLE TO IDLE BEFORE SHIFTING

LARGE SERIES

NEUTRAL CABLE ASSEMBLY
 MODEL AIR, AN, AP, U4-4 SUZUKI
 1318

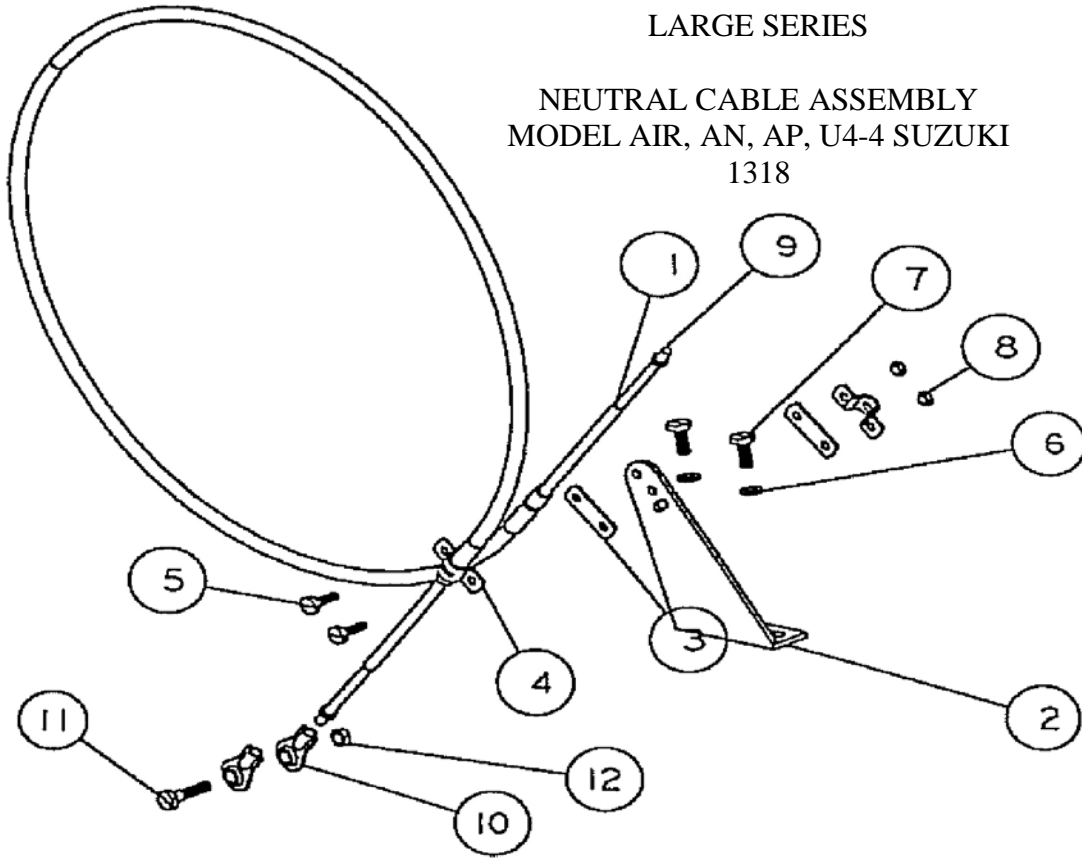

REF	QTY	PART NO.	DESCRIPTION
1	1	547.2	CABLE 5 FT MOR 33C SUPREME
2	1	156	BRACKET CABLE SUPT OMC, MORSE
3	2	542	SHIM MORSE A035777
4	2	543	CLAMP CHRYS 154317
5	2	561.1	FIL HD SLOTTED 10-24 X 3/4
6	2	635	1/4 WASHER AN960C416
7	2	572	BOLT HEX HD 1/4-20 X 5/8
8	2	619	NYLOC 10-24
9	2	621.1	NUT HEX 10-32
10	2	553.2	BALL END 1/4X10-32 CABLE
11	1	585	BOLT HEX HD 1/4-20 X 1 1/4
12	1	623	NYLOC 1/4-20

MEDIUM SERIES

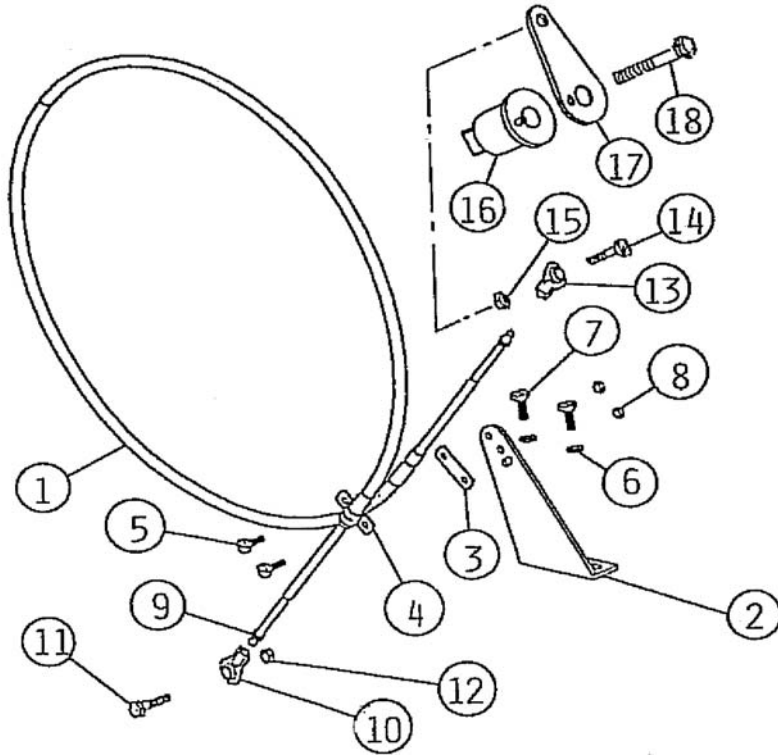

TILLER CABLE ASSEMBLY
SUZUKI MODEL U4-4
1592

REF	QTY	PART NO.	DESCRIPTION
1	1	547	CABLE 4 FT MOR 33C SUPREME
2	1	156	BRACKET CABLE SUPPORT
3	2	542	SHIM MORSE A035777
4	2	543	CLAMP CHRYS 154317
5	2	561	FIL HD SLOTTED 10-24 X 5/8
6	2	635	1/4 WASHER AN960C416
7	4	572	BOLT HEX HD 1/4-20 X 5/8
8	4	619	NYLOC 10-24
9	2	621.1	HEX NUT 10-32 JAM
10	1	553.2	BALL END 1/4X10-32 CABLE
11	1	573	BOLT HEX HD 1/4-20 X 3/4
12	1	623	NYLOC 1/4-20
13	1	553.1	BALL END #10 X 10-32 CABLE
14	1	558.4	PAN HD PHILLIPS 10-32 X 3/4
15	1	621	NYLOC 10-32
16	1	1594	LEVER MOUNT
17	1	1591	SHIFT LEVER
18	1	591.1	BOLT HEX HD M8 X 1.25