

SHIFT ROD ASSEMBLY
 EVINRUDE/JOHNSON MODELS H, H79
 227

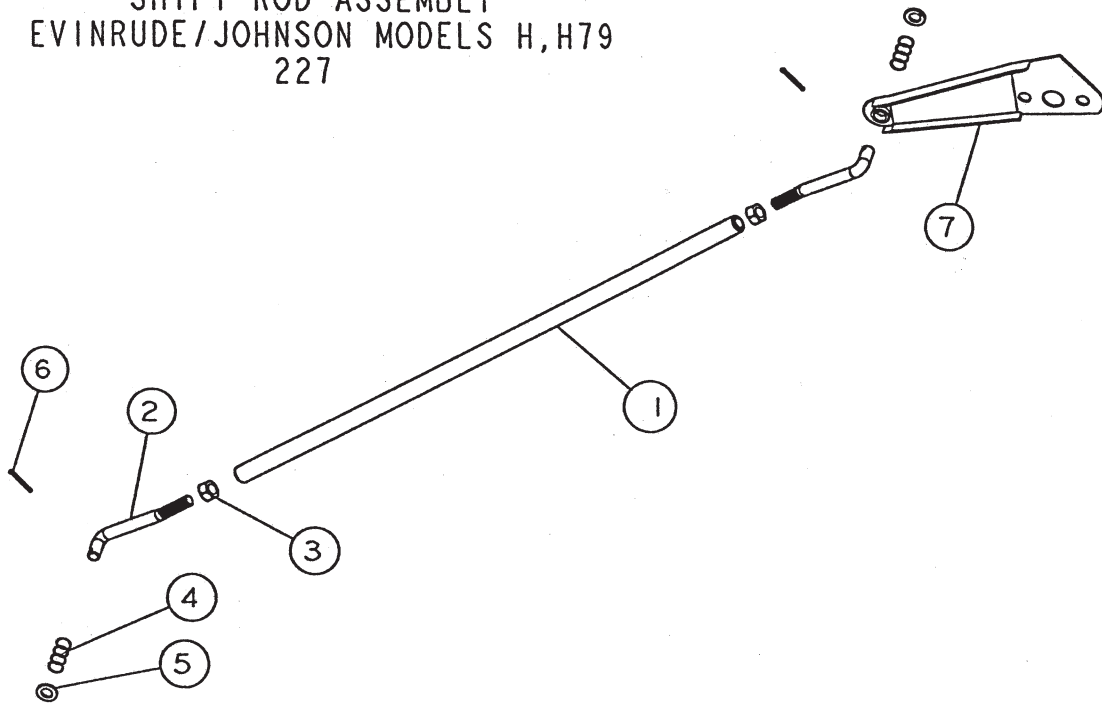

REF	QTY	PART NO	DESCRIPTION
1	1	219	SHIFT ROD H 14 5/16
2	2	24	ROD END FORMED
3	2	622	NUT HEX 1/4-28
4	2	1164	SPRING-ROD END
5	2	635	1/4 WASHER AN960C416
6	2	645	COTTER PIN 1/16 X 1/2
7	1	211	SHIFT LEVER HQ

7. AUG. 97